

we  
are  
arco

we  
make  
tables

arco

product

**Trestle table**

designer  
**Jorre van Ast**

Year  
**2017**

## Assembly instructions

Please follow step 1 - 8.

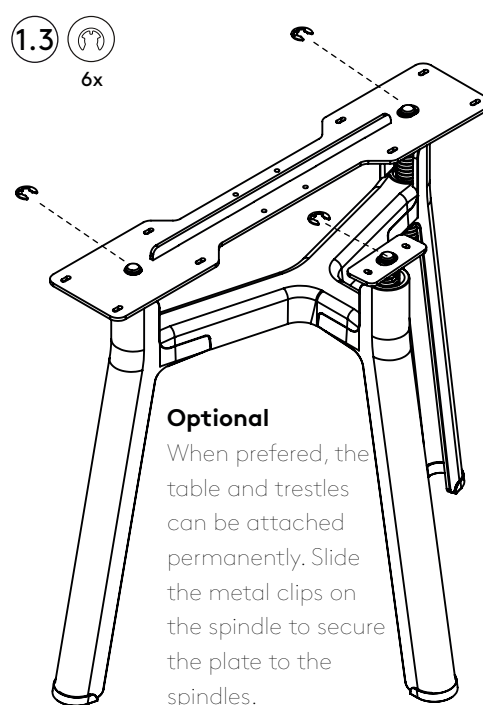
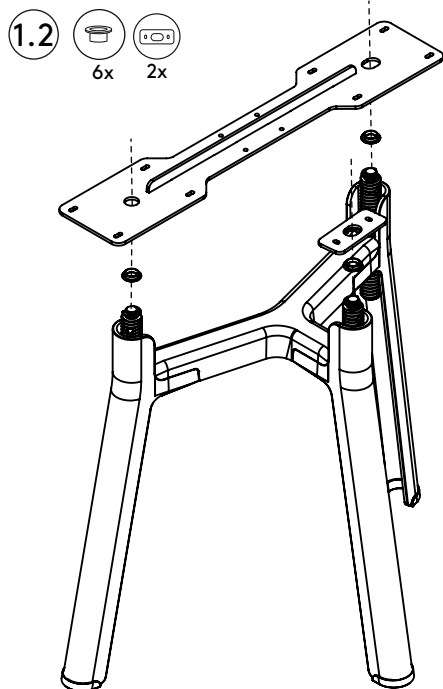
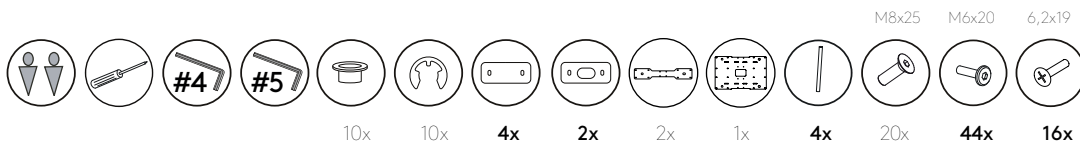

### Optional

When preferred, the table and trestles can be attached permanently. Slide the metal clips on the spindle to secure the plate to the spindles.

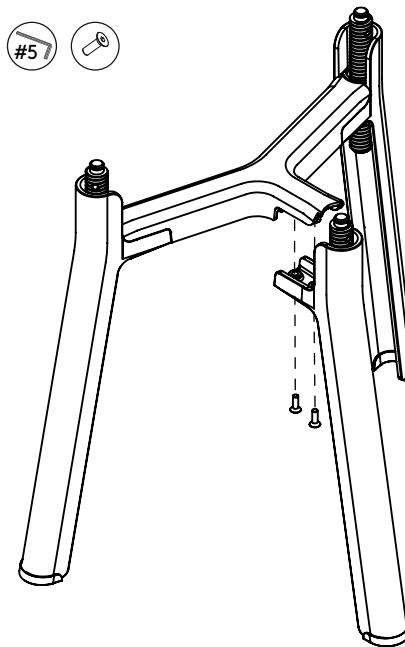

! - Make sure the holes align properly with the provided screws.

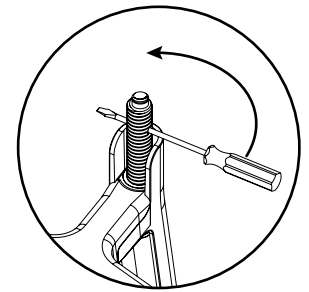

Turn the spindles until the hole is approximately 1cm above the top of the leg

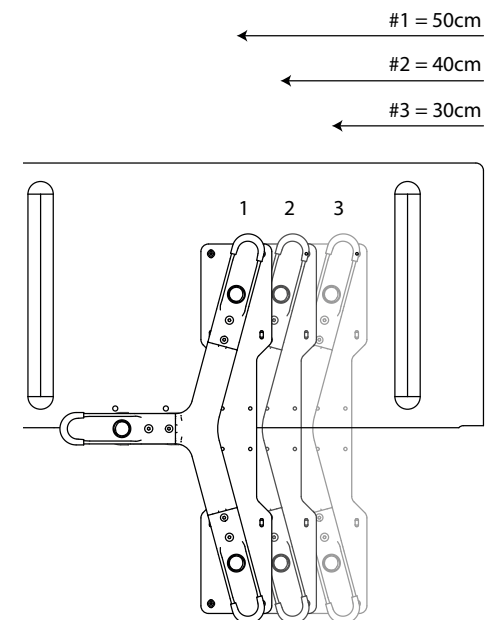
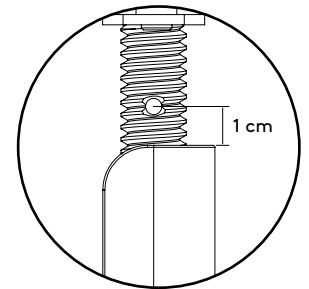

3 8x #4 4x

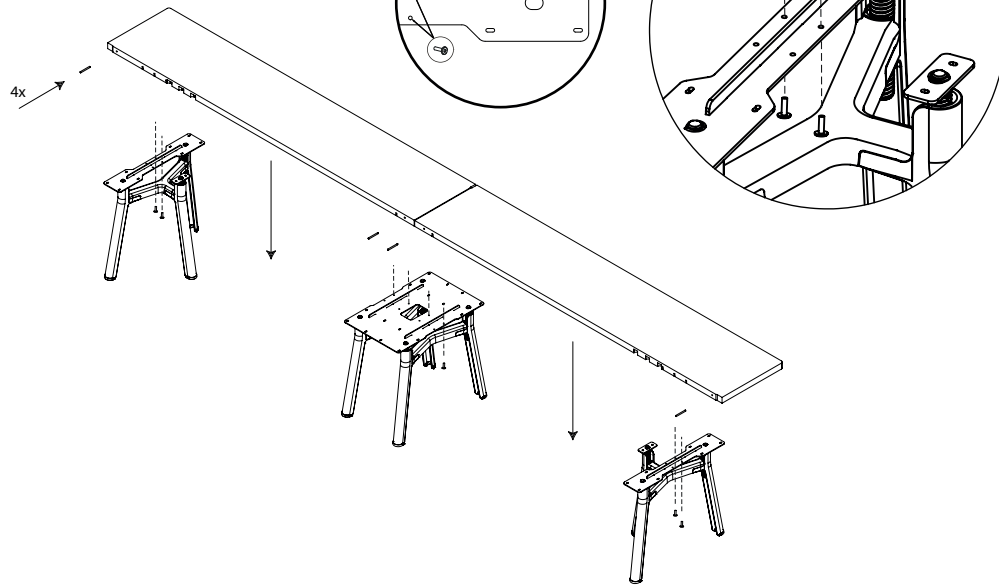

5

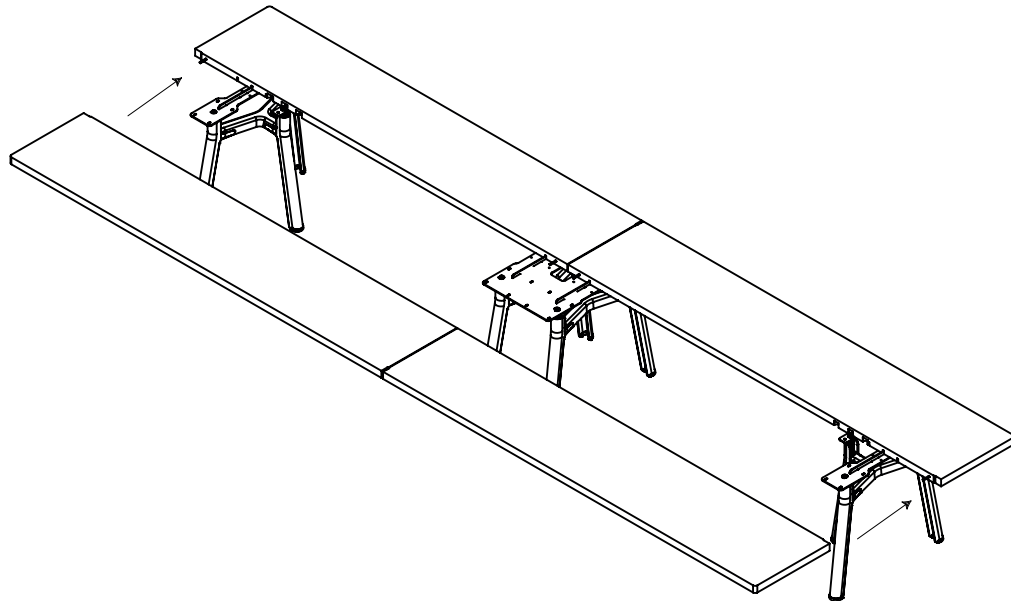

4 10x #4 8x

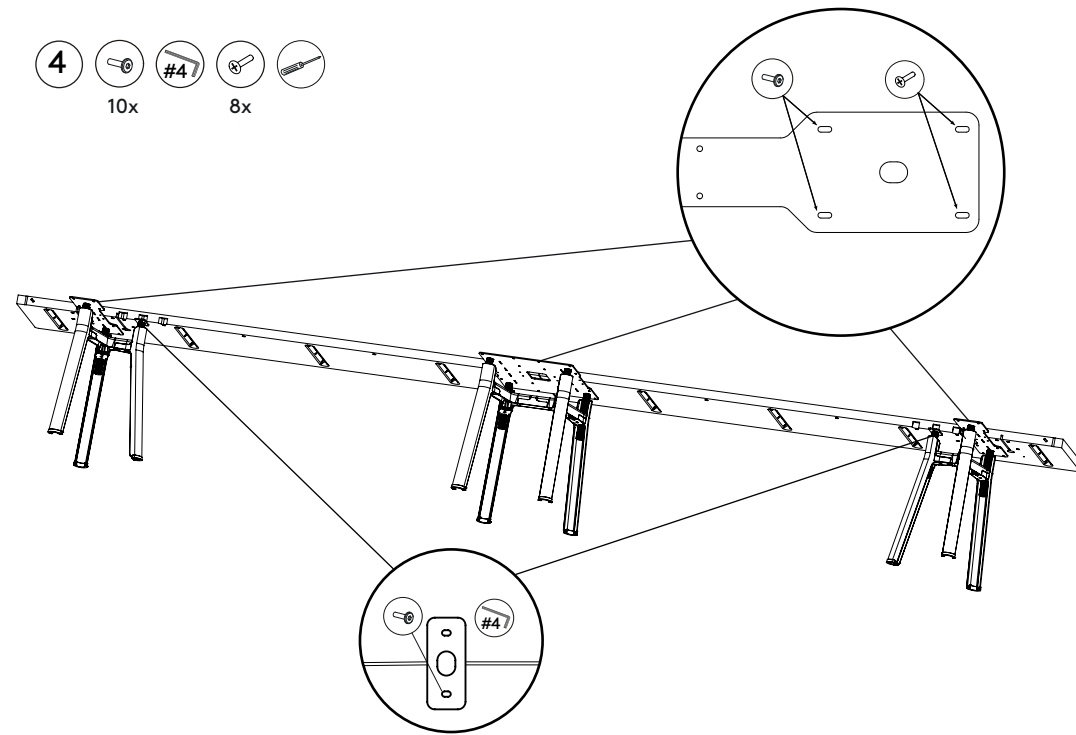

6 18x 8x

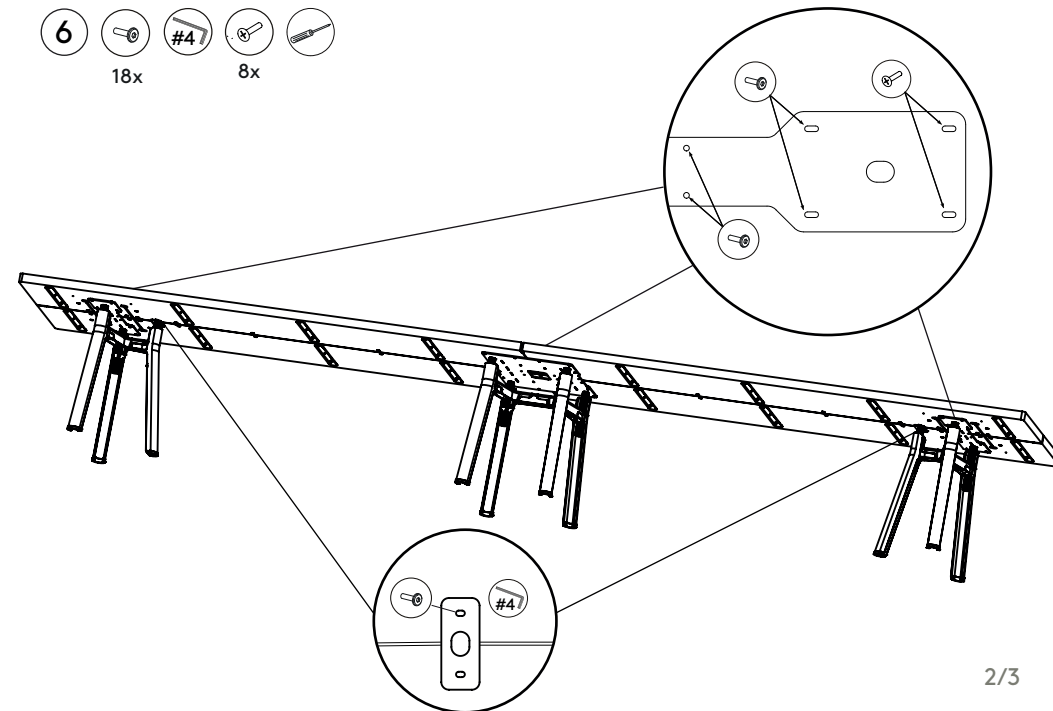

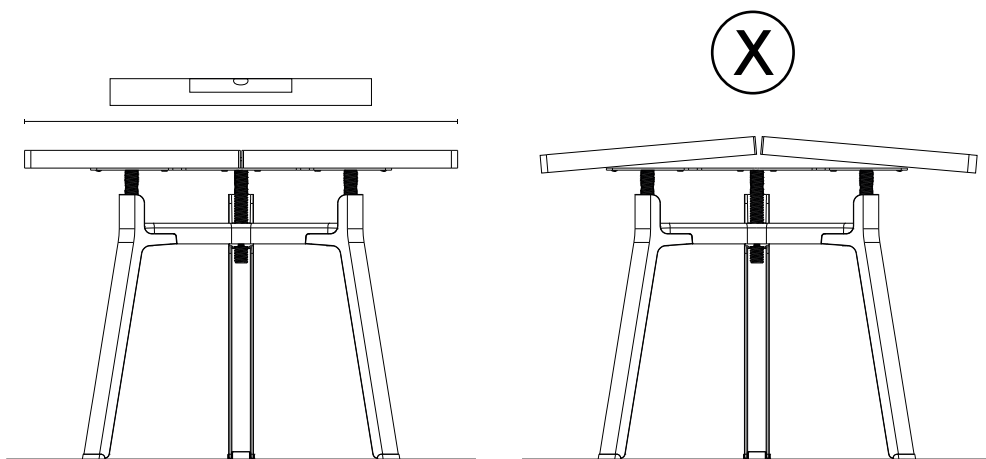
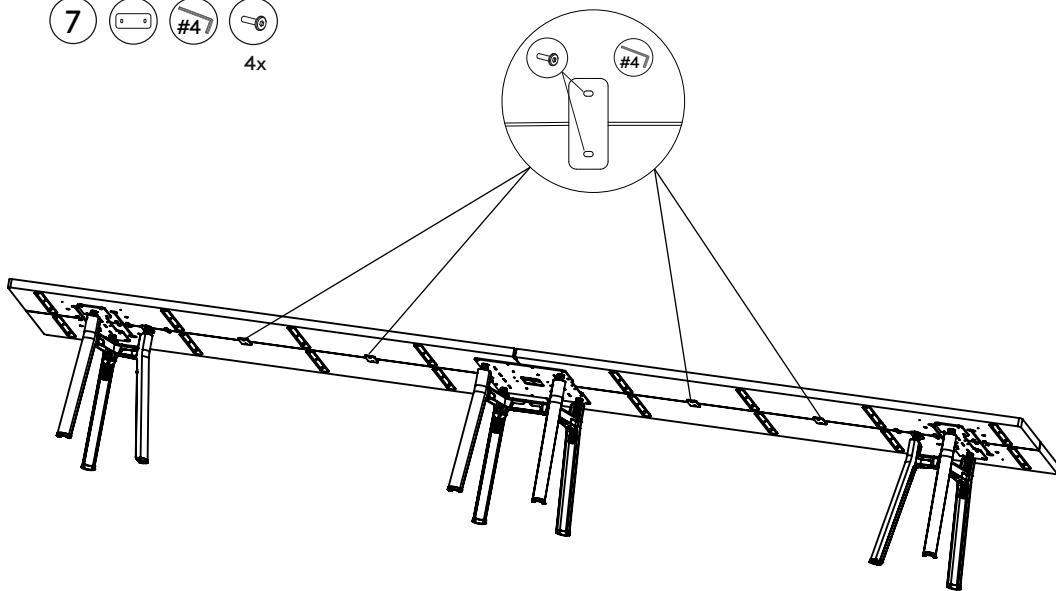
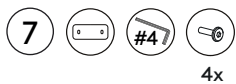

Make sure that the table is level

Make sure that the spindles are extended the to the same height

8

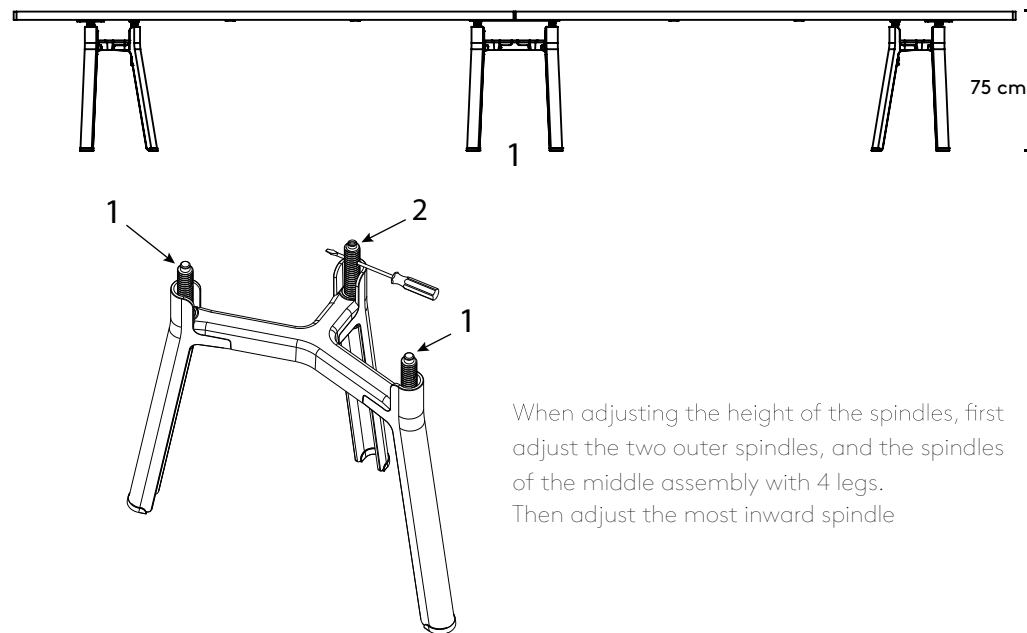

When adjusting the height of the spindles, first adjust the two outer spindles, and the spindles of the middle assembly with 4 legs. Then adjust the most inward spindle